



Medium Ratcheting QickClamp™ Tool - ZNPA198 Product Announcement

July 2009

Zurn PEX® proudly introduces the Medium Ratcheting QickClamp™ Tool. The new tool is very compact, making it the ideal tool when working in close quarters and hard to reach areas. Crimp completion is easy to recognize due to the LED light that illuminates when the required force to make a water tight crimp is applied to the QickClamp Ring. This tool also comes complete with a belt holster, making it convenient to carry around the job site.

QickClamp rings are available in four sizes (3/8", 1/2", 3/4" and 1"), and all sizes are compatible with the ratcheting QickClamp tool.

QickClamp rings are ideal for plumbing and heating applications, and are backed by Zurn's 25-year limited warranty.

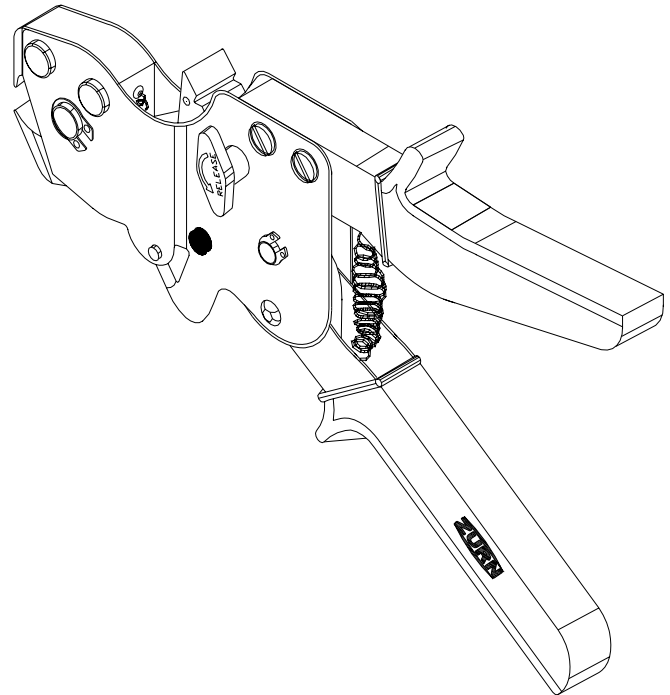

Product No.	Description	List Price (USD)	Availability	Category
QCRTQCRM	Medium Ratcheting QickClamp™ Tool	\$175.00	In Stock	13

See the attached product information for specific details:

Attachment 1: QCRTQCRM Medium Ratcheting QickClamp Tool Submittal

Attachment 2: ZPFN185 Medium Ratcheting QickClamp Crimp Ring Tool Operating Instructions

Contact your local distributor or sales representative for additional information



Medium Ratcheting QickClamp™ Tool - QCRTQCRM

Specification Sheet Tag _____

Dimensional Data: Inches and [mm] are subject to manufacturing tolerances and change without notice.

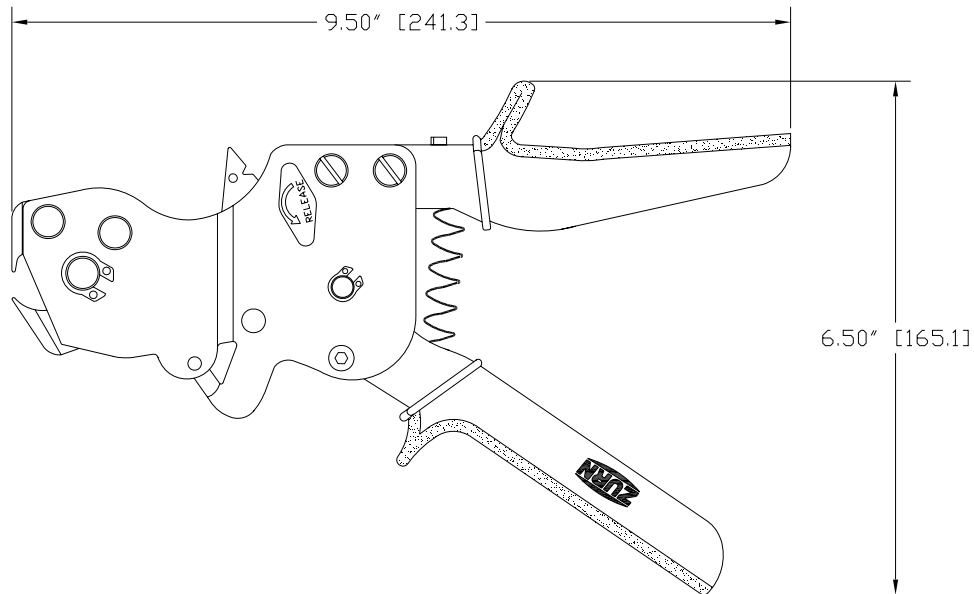

Engineering Specification: Zurn PEX® Ratcheting QickClamp™ Tool. The QCRTQCRM tool is intended for use with Zurn PEX QickClamps on Zurn PEX brass or copper insert fittings meeting the requirements of ASTM F 1807 and Zurn PEX CR fittings meeting the requirements of ASTM F 2159. This tool works with 3/8", 1/2", 3/4" and 1" QickClamps.

Accessories

- | | |
|------------|----------------------------|
| ___ QCLP2X | 3/8" QickClamp™ Crimp Ring |
| ___ QCLP3X | 1/2" QickClamp™ Crimp Ring |
| ___ QCLP4X | 3/4" QickClamp™ Crimp Ring |
| ___ QCLP5X | 1" QickClamp™ Crimp |

WARNING: Do Not Use This Tool with other pinch or cinch type clamps such as Zurn PEX SSC, Oetiker, Murray or Apollo. It is not intended for these clamps. System failures and property damage may occur if this tool is used with these clamps.

Rev.	Date: 6/12/09	C.N. No.120065
Dwg. No. 84227	Prod. No.QCRTQCRM	



Medium Ratcheting QickClamp™ Tool - QCRTQCRM Operating Instructions

Dimensional Data: Inches and [mm] are subject to manufacturing tolerances and change without notice.

Cutting Zurn PEX Tubing

Step 1: Using a blade type cutter, cut tubing to desired length.

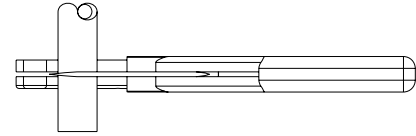

Install QickClamp

Step 2: Push tubing into the QickClamp until the tubing stops and is visible in the sight hole. **Be sure that the tab inside the QickClamp stays on the outside of the tubing.**



Incorrect
Assembly

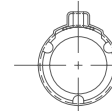

Correct
Assembly

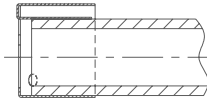

Install Fitting

Step 3: Push fitting into the tubing until the fitting shoulder touches the QickClamp.

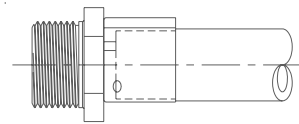

Crimp QickClamp

Step 4: Open the QCRTQCRM tool by turning the Release Knob counter-clockwise (Figure 1). Place the jaws completely over the QickClamp pinch ear. With the tool at a 90° angle to the tube (Figure 2), close the tool by squeezing the handles together repeatedly until the LED light comes on. This may take 6-8 squeezes (Figure 3).

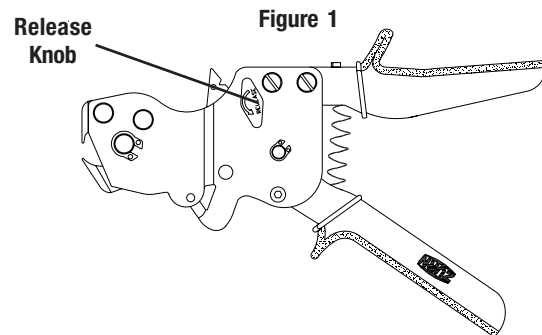

Figure 1

Important ! Be sure the tool jaws cover the entire ear of the QickClamp before crimping; failure to do so will result in an improper crimp and may void the warranty.

Step 5: It is very important to complete the crimping process before releasing the tool. Open the QCRTQCRM tool by turning the Release Knob counter-clockwise. Visually verify that a secure connection has been made. If the entire ear did not crimp, DO NOT recrimp. The QickClamp must be cut out and replaced.

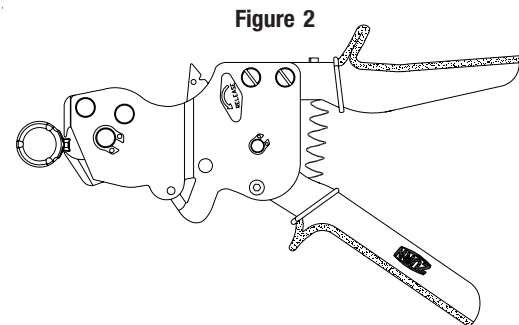

Figure 2

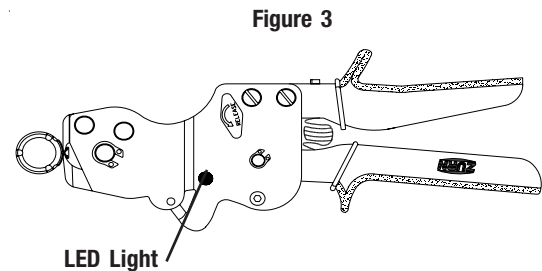

Figure 3

Form No. ZPFN185 Date: 6/11/09
C.N. No.120064 Rev.



Medium Ratcheting QickClamp™ Tool - QCRTQCRM Operating Instructions

The Zurn Medium Ratcheting QickClamp crimp tool is factory set to provide proper crimps. This should be checked before use by making a **test crimp** connection and checking it with the QickClamp Go Gauge. As long as the finished crimp connection gauges properly, there is no need to adjust the tool. **We recommend checking finished crimp connections frequently with the Zurn QickClamp Go Gauge.**

Using the QickClamp Go Gauge

Check a completed connection with the appropriate section of the QickClamp Go Gauge. Slide the appropriate slot of the gauge onto the crimped pinch ear. If the QickClamp pinch ear does not fit in the Go Gauge slot, the fitting should be cut out, the tool adjusted and the fitting replaced.

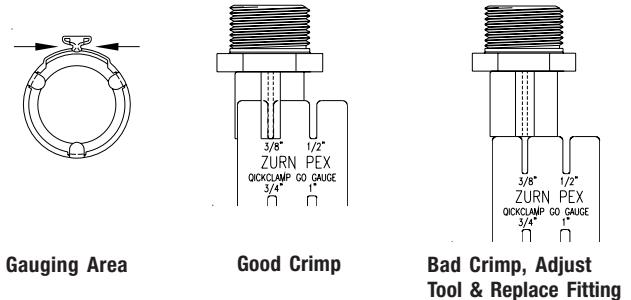

Adjusting Medium Ratcheting QickClamp Tool

- Step 1: Close the jaws about half-way with 3 or 4 squeezes of the handles (Figure 1).
- Step 2: Holding the tool with the jaws pointed toward you and the moving handle on top (Figure 2), find the Adjusting Screw on the ratchet arm. It is the lower screw that is visible through a small hole.
- Step 3: Use the allen wrench supplied with the tool to raise or lower the screw.
- Step 4: Raising the screw by turning counter-clockwise will cause the jaw gap to increase at the point the LED light comes on. It will be rare that this adjustment will be required.
- Step 5: Lowering the screw by turning clockwise will cause the jaw gap to decrease at the point the LED light comes on. Do not turn the screw more than ¼ turn at a time before making a test crimp and checking with the QickClamp Go Gauge. Do not adjust more than required to give finished clamps that gauge properly.

Figure 1

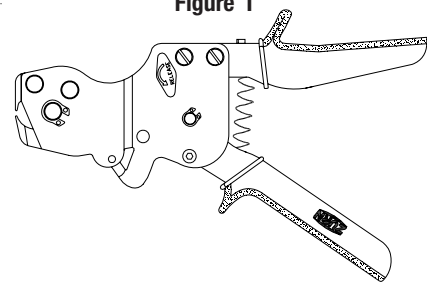
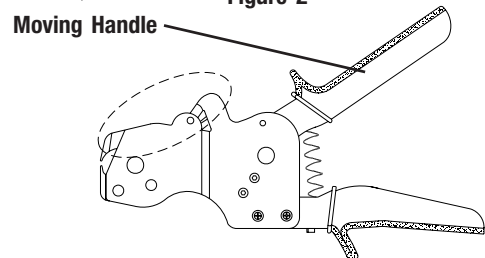
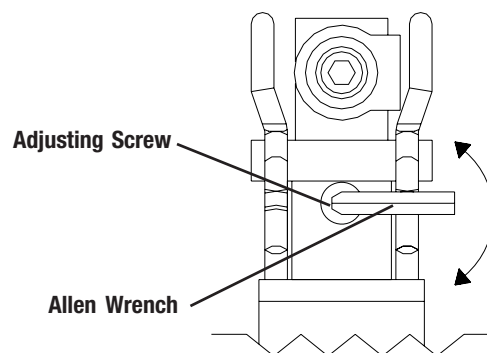

Figure 2



Detail Side View of
Adjusting Screw Area



Form No. ZPFN185 Date: 6/11/09
C.N. No.120064 Rev.